

PROJECT:
NELSON 43

LOCATION:
4301 78TH STREET S.W. MUKILTEO, WA

CLIENT:
**NELSON DEVELOPMENT
 P.O. BOX 1301
 SEAHURST, WA 98062**

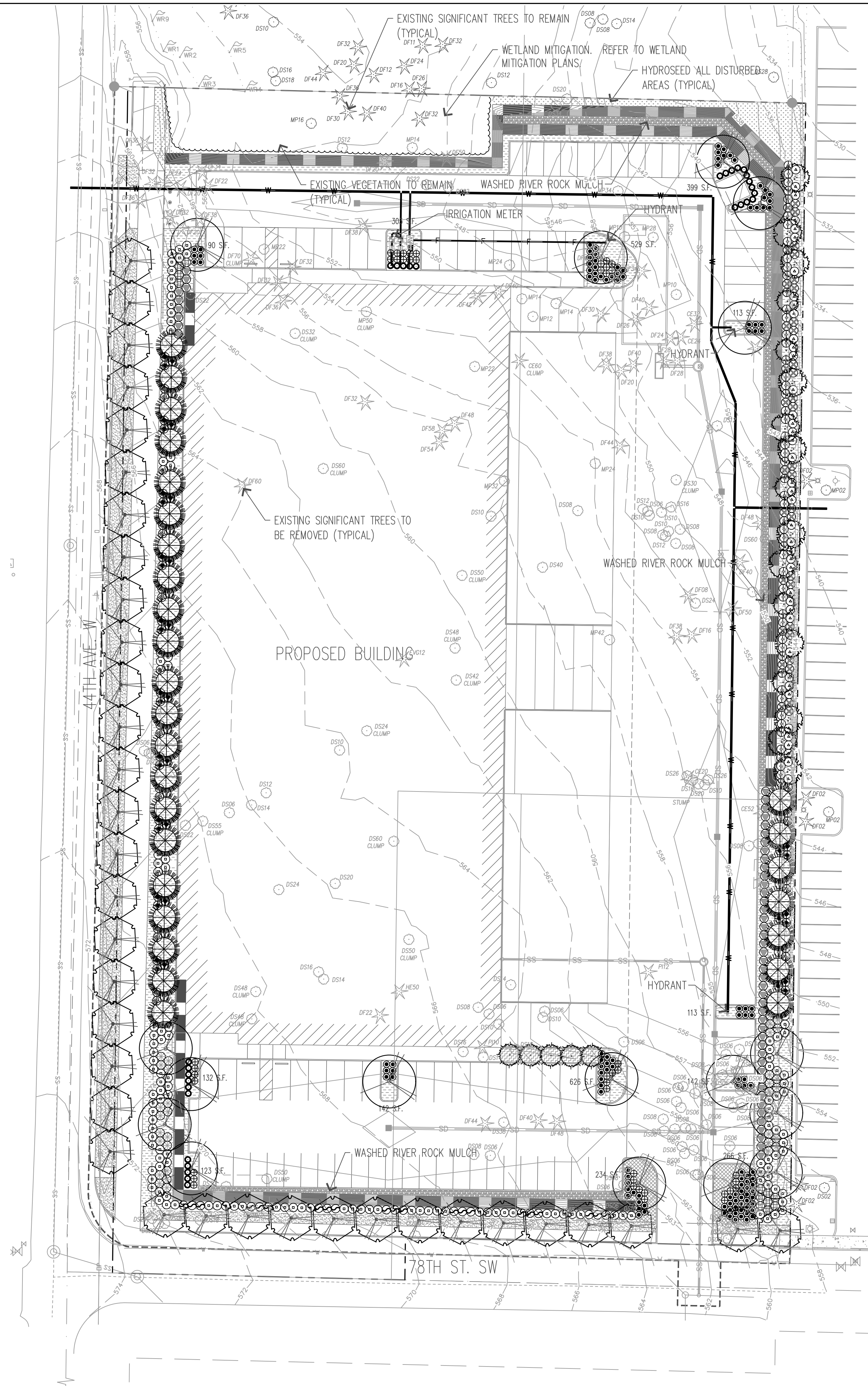

PLANT SCHEDULE

SYMBOL	BOTANICAL NAME / COMMON NAME	QTY	SIZE	REMARKS
DECIDUOUS TREES				
	ACER CIRCINATUM / VINE MAPLE	10	8-10' HT.	MULTI-STEM, B & B
	ACER T. X ACER P. 'WARRENRED' / PACIFIC SUNSET MAPLE	36	MIN. 2-1/2" CAL.	B & B
	FRAXINUS PENNSYLVANICA 'PATMORE' / PATMORE ASH	17	MIN. 2" CAL.	B & B
EVERGREEN TREES				
	CHAMAECYPARIS NOOT. PENDULA / ALASKA CEDAR	10	MIN. 6' HT.	B & B
	THUJA PLICATA 'EXCELSA' / WESTERN RED CEDAR	28	MIN. 6' HT.	B & B, FULL & BUSHY
EVERGREEN SHRUBS				
	ARBUTUS UNEDO 'COMPACTA' / STRAWBERRY TREE	83	5 GAL.	
	MAHONIA AQUIFOLIUM 'COMPACTA' / OREGON GRAPE	42	5 GAL.	
	OSMANTHUS H. 'GOSHIKI' / VARIEGATED OSMANTHUS	21	5 GAL.	
	PRUNUS L. 'OTTO LUYKEN' / OTTO LUYKEN LAUREL	126	5 GAL.	
	TAXUS MEDIA X HICKSII / HICKS YEW	29	B&B, MIN. 48" HT.	
	VIBURNUM DAVIDII / DAVID'S VIBURNUM	135	5 GAL.	
	VIBURNUM T. 'SPRING BOUQUET' / SPRING BOUQUET	53	5 GAL.	
DECIDUOUS SHRUBS				
	BERBERIS T. ATROPURPUREA 'BAGATELLE' / BARBERRY	42	5 GAL.	
	CORNUS SERICEA 'ARCTIC FIRE' / REDTWIG DOGWOOD	32	5 GAL.	
	EUONYMUS ALATUS 'COMPACTA' / WINGED EUONYMUS	12	5 GAL.	
	SPIRAEA JAPONICA 'GOLDFLAME' / GOLDFLAME SPIREA	39	5 GAL.	
	SYMPHORICARPOS ALBUS / SNOWBERRY	36	5 GAL.	
GROUNDCOVER				
	ARCHTOSTAPHYLOS UVA-URSI / KINNIKINNICK	TBD	4" POT	24" O.C.
	CORNUS S. 'KELSYI' / DWARF REDTWIG DOGWOOD	TBD	1 GAL.	24" O.C.
	GERANIUM MACRORRHIZUM / BIGROOT CRANESBILL	TBD	4" POT	24" O.C.
DROUGHT TOLERANT TURF / JB KEVLAR LS TALL FESCUE:				
	33.33% FIRECRACKER LS TALL FESCUE		HYDROSEED	SEED-300 LBS / ACRE MULCH-1,500 LBS / ACRE
	33.33% SPYDER LS TALL FESCUE			
	33.33% RAPTOR II TALL FESCUE			
WETLAND BUFFER SEED MIX:				
	10% AGROSTIS EXERATA / SPIKE BENTGRASS		HYDROSEED	SEED-80 LBS / ACRE MULCH-1,500 LBS / ACRE
	10% DESCHAMPSIA CESPITOSA / TUFTED HAIRGRASS			
	10% DESCHAMPSIA DANTHONIODES / ANNUAL HAIRGRASS			
	10% DESCHAMPSIA ELONGATA / SLENDER HAIRGRASS			
	25% ELYMUS GLASUCUS / BLUE WILDRIE			
	25% HORDEUM BRACHYANTHERUM / MEADOW BARLEY			
	10% LUPINUS POLYPHYLLUS / STREAMSIDE LUPINE			

NOTE:
 ALL PLANT MATERIAL HAS BEEN SELECTED TO BE NATIVE AND/OR DROUGHT TOLERANT.

LEGEND

2-10" DIA. WASHED RIVER ROCK MULCH
 MINIMUM 6" DEEP.

LANDSCAPE NOTES

- ALL NEW LANDSCAPE AREAS EXCLUDING WET BUFFER AREA AND RIVER ROCK MULCH AREA TO HAVE SUBGRADE SET 8" BELOW FINISH ELEVATION. THESE AREAS TO RECEIVE IMPORTED CEDAR GROVE 3-WAY TOPSOIL TO A MINIMUM OF 8" DEPTH. SUBGRADE TO BE SCARIFIED TO A DEPTH OF 12-18" AND ALL SPOILS (ROCK & DEBRIS > 4" DIA.) REMOVED PRIOR TO INSTALLATION OF IMPORTED TOPSOIL. TOPSOIL TO BE ADDED IN TWO LIFTS OF 4", WITH THE FIRST LIFT THOROUGHLY ROTOTILLED INTO THE SUBGRADE TO A DEPTH OF 6". ADDING ADDITIONAL TOPSOIL AS NEEDED TO PROVIDE A CROWN IN THE CENTER OF THE PLANTER WITH SIDE SLOPES OF 5%. TOPSOIL TO CONSIST OF EQUAL PARTS SANDY LOAM, SAND, AND COMPOST. TOPSOIL TO BE UNIFORMLY AMENDED FOR FERTILITY AND PH AS RECOMMENDED BY A CURRENT SOILS TEST PROVIDED BY A APPROVED SOIL TESTING LABORATORY FOR NEW PLANTING.
- ALL NEW PLANTER BEDS TO HAVE MEDIUM-FINE BARK MULCH OR APPROVED EQUAL INSTALLED TO A MINIMUM DEPTH OF 2". PROVIDE A 3" MULCH RING AROUND TRUNKS OF ALL TREES WITHIN LAWN AREA.
- GROUNDCOVER TO EXTEND UNDER ALL DECIDUOUS TREE CANOPIES AT THE SPECIFIED SPACING TO PROVIDE COMPLETE COVERAGE IN ALL PLANTING BEDS SHOWN TO RECEIVE GROUNDCOVER. GROUNDCOVER BENEATH EVERGREEN TREES TO MAINTAIN A 3' CLEARANCE FROM BASE OF TREE.
- ALL PLANT MATERIAL HAS BEEN SELECT TO BE DROUGHT TOLERANT. SUBSTITUTIONS IF REQUIRED TO ALSO BE DROUGHT TOLERANT, BE OF THE SAME GENERAL CHARACTER OF PLANT SUBSTITUTED, AND TO BE APPROVED BY LANDSCAPE ARCHITECT.
- B & B PLANTS TO BE DUG AND SECURED PRIOR TO THE END OF MARCH. WRITTEN CONFIRMATION FROM NURSERY TO BE SENT TO THE LANDSCAPE ARCHITECT.
- BURLAP TO BE COMPLETELY REMOVED FROM ALL B & B PLANT MATERIAL AND LOOSEN ROOTS OF POTTED PLANTS PRIOR TO BACKFILLING OF PLANTING. ALL STRAPS, TWINE, AND WIRE BASKETS TO BE REMOVED BEFORE PLANTING.
- ALL NEW PLANTING TO BE FERTILIZED WITH STARTER FERTILIZER 2-4-2, OR APPROVED EQUAL, APPLIED AT MANUFACTURERS RECOMMENDED RATE. TREES AND SHRUBS TO BE FERTILIZED WITH ACSAFE 20-10-5, 21 GRAM PLANT TABS, APPLIED AT MANUFACTURERS RECOMMENDED RATE.
- LANDSCAPE DRAWINGS ARE BASED ON THE SITE PLANS PREPARED BY SYNTHESIS PLLC. IMMEDIATELY NOTIFY LANDSCAPE ARCHITECT OF ANY FIELD CHANGES TO THE SITE PLAN THAT MAY REQUIRE ADJUSTMENT OF DESIGN.
- REFER TO CIVIL ENGINEERING DRAWINGS FOR GRADING AND DRAINAGE INFORMATION. IMMEDIATELY NOTIFY LANDSCAPE ARCHITECT ON ANY ADVERSE DRAINAGE CONDITIONS WHICH MAY AFFECT HEALTH OF PLANT MATERIAL.
- WARRANTY ALL PLANTING FOR 1 YEAR FROM FINAL ACCEPTANCE. REPLACE PLANTING THAT HAS DIED OR DYING.
- NO PRE-EMERGENT HERBICIDES TO BE USED ON THE PROJECT SITE DURING THE FIRST ONE YEAR WARRANTY PERIOD.
- ALL NEW LANDSCAPE AREAS TO HAVE A UNDERGROUND FULLY AUTOMATIC SMART IRRIGATION SYSTEM. PROVIDED WITH A ET/RAIN ADJUSTED SMART IRRIGATION CONTROLLER AND ON SITE SENSOR. IRRIGATION DISTRIBUTION COMPONENTS TO CONSIST OF DRIPLINE AND/OR MP ROTATORS ONLY.

LANDSCAPE PLAN

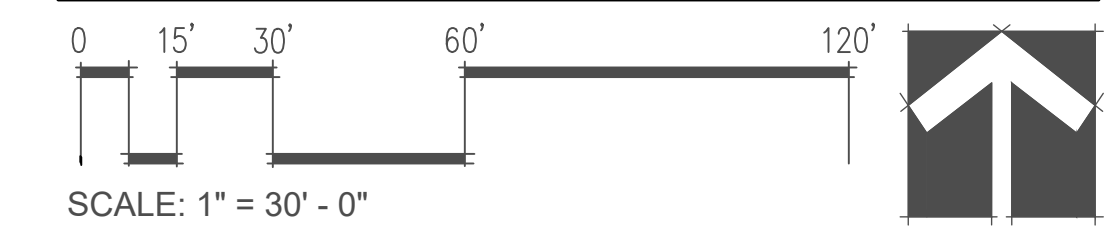

NO.	DATE	REVISION
10	07.2019	OWNER REVIEW
10	25.2019	PERMIT SET

DESIGNED CB
 DRAWN CB
 CHECKED CB

PROFESSIONAL SEAL

DATE 09.12.2019
 PROJECT NO. 201921

LANDSCAPE PLAN

SHEET NUMBER
L-1