



After Recording Please Return To:
CDD Administrator
Community Development Department
City of Mukilteo
11930 Cyrus Way
Mukilteo, WA 98275

AFFIDAVIT REGARDING LOT LINE ADJUSTMENT

STATE OF WASHINGTON) DATE: _____
COUNTY OF SNOHOMISH) ss NO: _____
CITY OF MUKILTEO) RECEIVED BY: _____
Name, address, and phone number of property owner(s): _____

Assessor parcel number(s): _____

1. Current Ownership: The undersigned is/are the owner(s) of the following described parcels of platted real property lying adjacent to each other (please describe each parcel separately):

A. Parcel No. 1:

B. Parcel No. 2:

C. Parcel No. 3:

2. Lot Line Adjustment: It is the intent of the undersigned to adjust the boundaries of the above described parcels with their free consent, in accordance with the desires of the owner(s) and, in accordance with MMC Chapter 16.20.10. Accordingly, it is represented and understood by the undersigned that:
- A. Neither of the lots affected are made substandard with respect to the requirements for lot size and dimensions, as required under the respective zoning district, as part of the zoning code. An existing lot, or parts of an existing lot, may be consolidated into the adjoining lots providing no substandard lot is created;
 - B. No existing building, or structure, is made substandard or nonconforming in any respect;
 - C. Existing easements are not jeopardized, or rendered impractical, to serve their purpose. (Ordinance No. 358 (part), 1981).
 - D. No new or additional lots or building sites are created;
 - E. No existing structures are rendered as nonconforming in any respect, nor is the nonconformity of an existing nonconforming structure or lot increased;
 - F. The creation of new streets, private roads or access easements, dedication of public right-of-way, or improvement of existing streets or private roads to meet current development standards are not required in order to provide access to the affected lots;
 - G. The orientation of existing lots will remain unchanged;
 - H. Encroachment on a critical area, buffer or setback to construct structures, driveways and parking areas will not be required; nor
 - I. Are any City or State codes violated?

AFTER ADJUSTMENT

A. Parcel No. 1:

B. Parcel No. 2:

On the basis of the representations hereby submitted, I conclude that the proposal is consistent with the requirements of MMC Section 16.20.010.

Date

I, _____, a registered Professional Land Surveyor, do hereby certify that the above legal descriptions created for this Boundary Line Adjustment are correct.

Date _____

Its: _____

I certify that I know or have satisfactory evidence that _____ the _____ of the Mukilteo School District No. 6 is/are the person(s) who appeared before me, and said person(s) acknowledged that he/she/they signed this instrument and acknowledged it to be his/her/their free and voluntary act for the uses and purposes mentioned in the above instrument.

Commission Expires _____

**EXHIBIT A
EXISTING LEGAL DESCRIPTION
PARCEL 1**

PARCEL 1, CITY OF MUKILTEO BOUNDARY LINE ADJUSTMENT NO. LLA-2014-001, RECORDED UNDER RECORDING NUMBER 201409165001, BEING A PORTION OF THE NORTHEAST QUARTER OF SECTION 9, TOWNSHIP 28 NORTH, RANGE 4 EAST, W.M., IN SNOHOMISH COUNTY WASHINGTON.

CONTAINING 497,406 SF, MORE OR LESS

**EXHIBIT B
EXISTING LEGAL DESCRIPTION
PARCEL 2**

PARCEL 2, CITY OF MUKILTEO BOUNDARY LINE ADJUSTMENT NO. LLA-2014-001, RECORDED UNDER RECORDING NUMBER 201409165001, BEING A PORTION OF THE NORTHEAST QUARTER OF SECTION 9, TOWNSHIP 28 NORTH, RANGE 4 EAST, W.M., IN SNOHOMISH COUNTY WASHINGTON.

EXCEPT THAT PORTION CONVEYED TO THE CITY OF MUKILTEO FOR RIGHT OF WAY, BY DEED RECORDED UNDER RECORDING NUMBER ~~XXXXXXXXXXXXXXXXXX~~, RECORDS OF SNOHOMISH COUNTY, WASHINGTON.

CONTAINING 76,129 SF, MORE OR LESS



EXHIBIT C
EXISTING LEGAL DESCRIPTION
PARCEL 3

PARCEL 3, CITY OF MUKILTEO BOUNDARY LINE ADJUSTMENT NO. LLA-2014-001, RECORDED UNDER RECORDING NUMBER 201409165001, BEING A PORTION OF THE NORTHEAST QUARTER OF SECTION 9, TOWNSHIP 28 NORTH, RANGE 4 EAST, W.M., IN SNOHOMISH COUNTY WASHINGTON.

CONTAINING 294,837 SF, MORE OR LESS

**EXHIBIT D
NEW LEGAL DESCRIPTION
PARCEL 1**

PARCEL 1, CITY OF MUKILTEO BOUNDARY LINE ADJUSTMENT NO. LLA-2014-001, RECORDED UNDER RECORDING NUMBER 201409165001, BEING A PORTION OF THE NORTHEAST QUARTER OF SECTION 9, TOWNSHIP 28 NORTH, RANGE 4 EAST, W.M., IN SNOHOMISH COUNTY WASHINGTON.

EXCEPT THAT PORTION OF SAID PARCEL 1, LYING NORTH OF THE FOLLOWING DESCRIBED LINE:

COMMENCING AT THE MOST NORTHERLY NORTHWEST CORNER OF SAID PARCEL 1;
THENCE SOUTH 01°45'43" WEST, ALONG THE WEST LINE OF SAID PARCEL 1, A DISTANCE OF 453.24 FEET TO THE MOST EASTERLY SOUTHEAST CORNER OF PARCEL 3 OF SAID CITY OF MUKILTEO BOUNDARY LINE ADJUSTMENT NO. LLA-2014-001 AND THE POINT OF BEGINNING;
THENCE NORTH 50°53'15" EAST, A DISTANCE OF 149.74 FEET;
THENCE SOUTH 88°39'49" EAST, A DISTANCE OF 216.78 FEET TO A POINT ON THE EAST LINE OF SAID PARCEL 1 THAT BEARS SOUTH 01°45'43" WEST, A DISTANCE OF 22.64 FEET FROM THE INTERSECTION OF SAID EAST LINE WITH THE SOUTH LINE OF THE NORTHWEST QUARTER OF THE NORTHEAST QUARTER OF SAID SECTION 9, SAID POINT BEING THE TERMINUS OF SAID LINE;

SITUATE IN THE COUNTY OF SNOHOMISH, STATE OF WASHINGTON.

CONTAINING 374,752 SF, MORE OR LESS

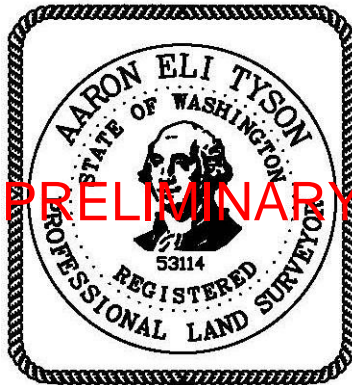

**EXHIBIT E
NEW LEGAL DESCRIPTION
PARCEL 2**

PARCEL 2 AND PARCEL 3, CITY OF MUKILTEO BOUNDARY LINE ADJUSTMENT NO. LLA-2014-001, RECORDED UNDER RECORDING NUMBER 201409165001, BEING A PORTION OF THE NORTHEAST QUARTER OF SECTION 9, TOWNSHIP 28 NORTH, RANGE 4 EAST, W.M., IN SNOHOMISH COUNTY WASHINGTON.

EXCEPT THAT PORTION OF SAID PARCEL 2, CONVEYED TO THE CITY OF MUKILTEO FOR RIGHT OF WAY, BY DEED RECORDED UNDER RECORDING NUMBER ~~XXXXXXXXXXXXXXXXXXXX~~, RECORDS OF SNOHOMISH COUNTY, WASHINGTON.

TOGETHER WITH THAT PORTION OF PARCEL 1, CITY OF MUKILTEO BOUNDARY LINE ADJUSTMENT NO. LLA-2014-001, RECORDED UNDER RECORDING NUMBER 201409165001, LYING NORTH OF THE FOLLOWING DESCRIBED LINE:

COMMENCING AT THE MOST NORTHERLY NORTHWEST CORNER OF SAID PARCEL 1;
THENCE SOUTH 01°45'43" WEST, ALONG THE WEST LINE OF SAID PARCEL 1, A DISTANCE OF 453.24 FEET TO THE MOST EASTERLY SOUTHEAST CORNER OF PARCEL 3 OF SAID CITY OF MUKILTEO BOUNDARY LINE ADJUSTMENT NO. LLA-2014-001 AND THE POINT OF BEGINNING;
THENCE NORTH 50°53'15" EAST, A DISTANCE OF 149.74 FEET;
THENCE SOUTH 88°39'49" EAST, A DISTANCE OF 216.78 FEET TO A POINT ON THE EAST LINE OF SAID PARCEL 1 THAT BEARS SOUTH 01°45'43" WEST, A DISTANCE OF 22.64 FEET FROM THE INTERSECTION OF SAID EAST LINE WITH THE SOUTH LINE OF THE NORTHWEST QUARTER OF THE NORTHEAST QUARTER OF SAID SECTION 9, SAID POINT BEING THE TERMINUS OF SAID LINE;

SITUATE IN THE COUNTY OF SNOHOMISH, STATE OF WASHINGTON.

CONTAINING 493,620 SF, MORE OR LESS

